

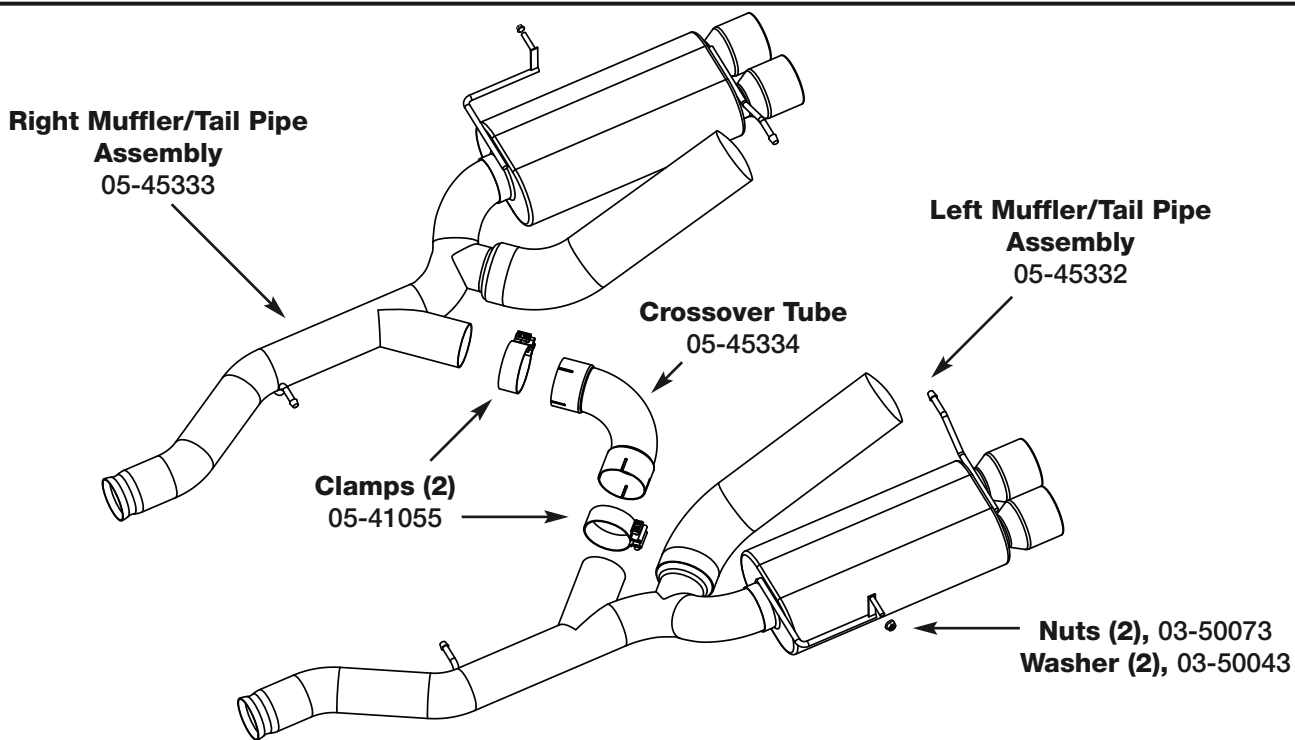

## INSTALLATION INSTRUCTIONS

MAKE: BMW  
MODEL: M3  
YEAR: 2008-2010  
ENGINE: V8-4.0L



**Step 1:** (Read Instructions prior to installation) *It is recommended to not fully tighten the clamps until the entire system has been installed.* Loosen 13mm spherical band clamps completely and slide forward.

**Step 2:** Remove (2) 18 mm head upper hanger mounts nuts at differential.

**Step 3:** Support rear of muffler assembly with a work stand.

**Step 4:** Remove (4) 8 mm head screws under rear apron. This will allow removal of the entire rear mounts with the exhaust removal.

**Step 5:** Remove the (4) 13 mm head nuts at the muffler side mounts.

**Step 6:** Pivot the differential hanger mounts down, pull exhaust system rear, down and forward to lower all hanger mounts with the complete OE exhaust system.

**Step 7:** Lay OE and aFe exhaust systems side-by-side and transfer hanger mounts. Note muffler side mounts are not symmetrical and the center mounting screw should be towards the front of the exhaust system.

**Step 8:** With band clamps loosely assemble right, center and left tube assembly. With assistance lift exhaust system into position and attach muffler side mount nuts but do not tighten. Slip on front OE band clamps and tighten slightly. Install the rear hangers.

**Step 9:** Adjustments can be made at the crossover tube and long muffler hangers. position crossover tube band clamps so they do not touch differential cover. **IMPORTANT!!! Tips should be centered in rear apron cut outs. Failure to do this step can result in melted apron which aFe is not responsible for!**

**Step 10:** Tighten all mounts and clamps. Check and retighten after 150 miles.

### NOTE:

- IF additional clearance is needed, the soft aluminum heat shields can be reshaped at any points of contact.

**Caution:** Allow time for your vehicle to cool down prior to installation. When working on or under your vehicle proceed with caution. Exhaust systems reach high temperatures and may cause serious burns. Wear protective safety equipment; eye goggles and gloves to ensure a safe installation. aFe recommends professional installation on our products.